



- 1
- 2
- 3
- 4
- 5
- 6
- 7
- 8
- 9
- 10
- 11
- 12
- 13
- 14
- 15
- 16
- 17
- 18

STANDARD EXECUTIONS

- **DVA.5:** bushing with threaded blind hole and base plate in polished zinc-plated steel, vibration-damper body in natural rubber NR, black colour, hardness 40, 55, 70 Shore A ± 5 .
- **DVA.5-SST:** bushing with threaded blind hole and base plate in AISI 304 stainless steel, vibration-damper body in natural rubber NR, black colour, hardness 55 Shore A ± 5 .

FEATURES AND APPLICATIONS

The rubber buffers have been designed to damp vibrations, shocks and noises produced by moving bodies or non-balanced vibrating masses of equipment and machines which can cause:

- malfunctioning and reduction of the machine lifespan and/or of the adjacent ones;
- damage to health;
- noise.

Load diagrams for each single code are available on request. See Technical data and guidelines for the choice (on page 728).

SPECIAL EXECUTIONS ON REQUEST

Natural rubber NR, hardness 40, 70 tolerance ± 5 Shore A for executions with AISI 304 stainless steel base.



DVA.5

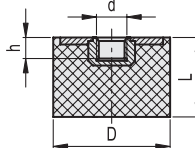

* Complete the description with the desired hardness: 40, 55 or 70 tolerance ± 5 Shore A.

DVA.5 - 10 - 10 - M4 - 55
D L d Shore A

Conversion Table					
1 mm = 0.039 inch					
D			L		
mm	inch	mm	inch	mm	inch
8	0.31	50	1.97	8	0.31
10	0.39	60	2.36	10	0.39
15	0.59	70	2.76	13	0.51
20	0.79	75	2.95	15	0.59
25	0.98	100	3.94	17	0.67
30	1.18	125	4.92	20	0.79
40	1.57	200	7.80	25	0.98



DVA.5

Description	D	L	d	h	⚖️	Hardness 40 Shore A			Hardness 55 Shore A			Hardness 70 Shore A					
						Code	Max load [N]	Max deflection [mm]	Stiffness [N/mm]	Code	Max load [N]	Max deflection [mm]	Stiffness [N/mm]	Code	Max load [N]	Max deflection [mm]	Stiffness [N/mm]
DVA.5-8-8-M3*	8	8	M3	3	1	415691	34	2	17	413029	55	2	28	418391	141	2	71
DVA.5-8-13-M3*	8	13	M3	3	2	415693	33	3	10	413030	52	3	16	418393	133	3	41
DVA.5-10-10-M4*	10	10	M4	4	2	415701	54	3	21	413031	88	3	35	418401	217	3	87
DVA.5-10-15-M4*	10	15	M4	4	2	415703	69	4	18	413033	92	4	25	418403	175	4	47
DVA.5-15-15-M4*	15	15	M4	4	5	415711	141	4	38	413041	259	4	69	418411	384	4	102
DVA.5-15-20-M4*	15	20	M4	4	6	415721	134	5	27	413051	223	5	45	418421	590	5	118
DVA.5-20-15-M6*	20	15	M6	6	10	415731	289	4	77	413061	468	4	125	418431	704	4	188
DVA.5-20-20-M6*	20	20	M6	6	11	415741	258	5	52	413071	367	5	73	418441	809	5	162
DVA.5-20-25-M6*	20	25	M6	6	13	415751	250	6	40	413081	437	6	70	418451	750	6	120
DVA.5-20-30-M6*	20	30	M6	6	15	415756	285	7	38	413086	410	7	55	418456	615	7	82
DVA.5-25-15-M6*	25	15	M6	6	16	415761	485	4	129	413091	797	4	213	418461	1627	4	434
DVA.5-25-20-M6*	25	20	M6	6	20	415771	416	5	83	413101	581	5	116	418471	1382	5	276
DVA.5-25-25-M6*	25	25	M6	6	21	415776	510	6	82	413105	635	6	102	418476	1262	6	202
DVA.5-25-30-M6*	25	30	M6	6	21	415781	290	8	39	413106	591	8	79	418481	1186	8	158

Vibration damping elements

* Complete the description with the desired hardness:
40, 55 or 70 tolerance ±5 Shore A.

DVA.5 - 10 - 10 - M4 - 55
 D L d Shore A

DVA.5

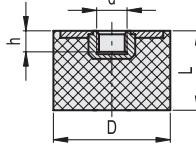

D			L		
mm	inch	mm	inch	mm	inch
8	0.31	50	1.97	8	0.31
10	0.39	60	2.36	10	0.39
15	0.59	70	2.76	13	0.51
20	0.79	75	2.95	15	0.59
25	0.98	100	3.94	17	0.67
30	1.18	125	4.92	20	0.79
40	1.57	200	7.80	25	0.98
				30	1.18
				40	1.57
				50	1.97
				60	2.36
				75	2.95

DVA.5

METRIC

Description	D	L	d	h	⚖	Hardness 40 Shore A			Hardness 55 Shore A			Hardness 70 Shore A					
						Code	Max load [N]	Max deflection [mm]	Stiffness [N/mm]	Code	Max load [N]	Max deflection [mm]	Stiffness [N/mm]	Code	Max load [N]	Max deflection [mm]	Stiffness [N/mm]
DVA.5-30-15-M8*	30	15	M8	8	23	415791	746	3	249	413111	1023	3	341	418491	2610	3	870
DVA.5-30-17-M8*	30	17	M8	8	25	415801	772	3	257	413121	1275	3	425	418501	2447	3	816
DVA.5-30-20-M8*	30	20	M8	8	27	415811	567	5	113	413141	1014	5	203	418511	1878	5	376
DVA.5-30-25-M6*	30	25	M6	6	29	415816	495	6	79	413143	960	6	153	418516	1565	6	250
DVA.5-30-30-M8*	30	30	M8	8	34	415821	601	8	80	413146	776	8	103	418521	1616	8	215
DVA.5-30-40-M8*	30	40	M8	8	43	415823	550	10	55	413148	780	10	78	418523	1785	10	179
DVA.5-40-20-M8*	40	20	M8	8	45	415831	1200	5	240	413151	2500	5	500	418531	4750	5	950
DVA.5-40-20-M10*	40	20	M10	10	44	415857	1115	5	223	413176	1623	5	325	418557	5600	5	1120
DVA.5-40-30-M8*	40	30	M8	8	65	415841	1140	8	152	413161	1480	8	197	418541	2830	8	377
DVA.5-40-40-M8*	40	40	M8	8	75	415851	995	10	100	413171	1403	10	140	418551	3150	10	315
DVA.5-40-50-M8*	40	50	M8	8	90	415853	1005	13	80	413173	1397	13	112	418553	2382	13	191
DVA.5-50-20-M10*	50	20	M10	10	77	415861	2680	5	536	413181	3460	5	692	418561	7450	5	1490
DVA.5-50-30-M10*	50	30	M10	10	100	415871	1820	8	243	413183	2520	8	336	418571	5420	8	723
DVA.5-50-35-M10*	50	35	M10	10	105	415876	1715	8	196	413184	2530	8	289	418576	4160	8	475
DVA.5-50-40-M10*	50	40	M10	10	115	415881	1430	10	143	413186	2760	10	276	418581	4950	10	495
DVA.5-50-45-M10*	50	45	M10	10	118	415883	1605	11	142	413187	2510	11	223	418583	4810	11	427
DVA.5-50-50-M10*	50	50	M10	10	123	415886	1610	12	129	413188	2570	12	206	418586	4860	12	389
DVA.5-60-30-M10*	60	30	M10	10	141	415891	2800	8	373	413191	4350	8	580	418591	7500	8	1000
DVA.5-60-40-M10*	60	40	M10	10	170	415895	2600	10	260	413192	3540	10	354	418595	4640	10	464
DVA.5-60-50-M10*	60	50	M10	10	205	415901	2900	13	232	413193	4370	13	350	418601	9500	13	760
DVA.5-70-30-M10*	70	30	M10	10	195	415907	4930	8	657	413195	7170	8	956	418607	13070	8	1743
DVA.5-70-40-M10*	70	40	M10	10	255	415911	3850	10	385	413196	6280	10	628	418611	15280	10	1528
DVA.5-70-45-M10*	70	45	M10	10	275	415921	3700	11	329	413201	6750	11	600	418621	8800	11	782
DVA.5-70-55-M10*	70	55	M10	10	341	415931	3320	14	241	413211	5770	14	420	418631	9510	14	692
DVA.5-75-25-M12*	75	25	M12	12	205	415941	6560	5	1312	413221	9660	5	1932	418641	20780	5	4156
DVA.5-75-30-M12*	75	30	M12	12	210	415951	5400	8	720	413226	8700	8	1160	418651	15400	8	2053
DVA.5-75-40-M12*	75	40	M12	12	290	415961	5010	10	501	413231	6680	10	668	418661	9170	10	917
DVA.5-75-50-M12*	75	50	M12	12	345	415971	3970	13	318	413241	5570	13	446	418671	13550	13	1084
DVA.5-75-55-M12*	75	55	M12	12	348	415976	5050	13	367	413189	6820	13	496	418676	10590	13	770
DVA.5-100-40-M16*	100	40	M16	16	485	415981	9430	10	943	413261	12110	10	1211	418681	24190	10	2419
DVA.5-100-50-M16*	100	50	M16	16	580	415991	8320	13	666	413281	14040	13	1123	418691	22900	13	1832
DVA.5-100-55-M16*	100	55	M16	16	583	415996	7820	13	568	413286	12730	13	925	418696	22800	13	1658
DVA.5-100-60-M16*	100	60	M16	16	720	416001	7440	15	496	413291	12950	15	863	418701	21450	15	1430
DVA.5-125-55-M16*	125	55	M16	16	1050	416021	21217	14	1543	413321	23790	13	1809	418721	23751	11	2102
DVA.5-125-75-M16*	125	75	M16	16	1212	416031	18723	19	999	413331	22314	19	1190	418731	25000	18	1420
DVA.5-150-75-M20*	150	75	M20	20	1325	416041	18050	18	962	413341	27800	18	1482	418741	28600	11	2600
DVA.5-200-100-M20*	200	100	M20	20	1950	416051	9280	8	1160	413351	11540	8	1442	418761	22770	5	4554



Vibration damping elements



DVA.5 - 10 - 10 - SST - M4 - 55
 D L Stainless steel d Shore A

DVA.5-SST

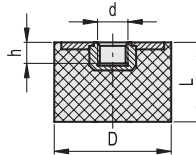

D		L	
mm	inch	mm	inch
8	0.31	50	1.97
10	0.39	60	2.36
15	0.59	70	2.76
20	0.79	75	2.95
25	0.98	100	3.94
30	1.18	125	4.92
40	1.57	200	7.80

DVA.5-SST

INOX STAINLESS STEEL METRIC

Description	D	L	d	h	⚖️	Code	Hardness 40 Shore A			Hardness 55 Shore A			Hardness 70 Shore A				
							Max load [N]	Max deflection [mm]	Stiffness [N/mm]	Code	Max load [N]	Max deflection [mm]	Stiffness [N/mm]	Code	Max load [N]	Max deflection [mm]	Stiffness [N/mm]
DVA.5-8-8-SST-M3-55	8	8	M3	3	1		34	2	17	410398	55	2	28		141	2	71
DVA.5-8-13-SST-M3-55	8	13	M3	3	2		33	3	10	410399	52	3	16		133	3	41
DVA.5-10-10-SST-M4-55	10	10	M4	4	2		54	3	21	410401	88	3	35		217	3	87
DVA.5-10-15-SST-M4-55	10	15	M4	4	2		69	4	18	410403	92	4	25		175	4	47
DVA.5-15-15-SST-M4-55	15	15	M4	4	5		141	4	38	410405	259	4	69		384	4	102
DVA.5-15-20-SST-M4-55	15	20	M4	4	6		134	5	27	410407	223	5	45		590	5	118
DVA.5-20-15-SST-M6-55	20	15	M6	6	10		289	4	77	410413	468	4	125		704	4	188
DVA.5-20-20-SST-M6-55	20	20	M6	6	11		258	5	52	410415	367	5	73		809	5	162
DVA.5-20-25-SST-M6-55	20	25	M6	6	13		250	6	40	410417	437	6	70		750	6	120
DVA.5-20-30-SST-M6-55	20	30	M6	6	15		285	7	38	410419	410	7	55		615	7	82
DVA.5-25-15-SST-M6-55	25	15	M6	6	16		485	4	129	410421	797	4	213		1627	4	434
DVA.5-25-20-SST-M6-55	25	20	M6	6	20		416	5	83	410425	581	5	116		1382	5	276
DVA.5-25-25-SST-M6-55	25	25	M6	6	21		510	6	82	410426	635	6	102		1262	6	202
DVA.5-25-30-SST-M6-55	25	30	M6	6	21		290	8	39	410427	591	8	79		1186	8	158

Vibration damping elements

DVA.5 - 10 - 10 - SST - M4 - 55
 D L Stainless steel d Shore A

DVA.5-SST

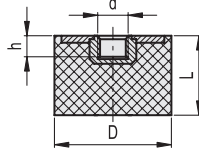

D			L		
mm	inch	mm	inch	mm	inch
8	0.31	50	1.97	8	0.31
10	0.39	60	2.36	10	0.39
15	0.59	70	2.76	13	0.51
20	0.79	75	2.95	15	0.59
25	0.98	100	3.94	17	0.67
30	1.18	125	4.92	20	0.79
40	1.57	200	7.80	25	0.98

DVA.5-SST

INOX STAINLESS STEEL METRIC

Description	D	L	d	h	△	Hardness 40 Shore A			Hardness 55 Shore A			Hardness 70 Shore A					
						Code	Max load [N]	Max deflection [mm]	Stiffness [N/mm]	Code	Max load [N]	Max deflection [mm]	Stiffness [N/mm]	Code	Max load [N]	Max deflection [mm]	Stiffness [N/mm]
DVA.5-30-15-SST-M8-55	30	15	M8	8	23		746	3	249	410431	1023	3	341		2610	3	870
DVA.5-30-17-SST-M8-55	30	17	M8	8	25		772	3	257	410433	1275	3	425		2447	3	816
DVA.5-30-20-SST-M8-55	30	20	M8	8	27		567	5	113	410435	1014	5	203		1878	5	376
DVA.5-30-25-SST-M6-55	30	25	M6	6	30		495	6	79	410436	960	6	153		1565	6	250
DVA.5-30-30-SST-M8-55	30	30	M8	8	34		601	8	80	410437	776	8	103		1616	8	215
DVA.5-30-40-SST-M8-55	30	40	M8	8	43		550	10	55	410439	780	10	78		1785	10	179
DVA.5-40-20-SST-M8-55	40	20	M8	8	45		1200	5	240	410441	2500	5	500		4750	5	950
DVA.5-40-20-SST-M10-55	40	20	M10	10	44		1115	5	223	410449	1623	5	325		5600	5	1120
DVA.5-40-30-SST-M8-55	40	30	M8	8	65		1140	8	152	410443	1480	8	197		2830	8	377
DVA.5-40-40-SST-M8-55	40	40	M8	8	75		995	10	100	410445	1403	10	140		3150	10	315
DVA.5-40-50-SST-M8-55	40	50	M8	8	90		1005	13	80	410447	1397	13	112		2382	13	191
DVA.5-50-20-SST-M10-55	50	20	M10	10	77		2680	5	536	410451	3460	5	692		7450	5	1490
DVA.5-50-30-SST-M10-55	50	30	M10	10	100		1820	8	243	410453	2520	8	336		5420	8	723
DVA.5-50-35-SST-M10-55	50	35	M10	10	105		1715	8	196	410454	2530	8	289		4160	8	475
DVA.5-50-40-SST-M10-55	50	40	M10	10	115		1430	10	143	410455	2760	10	276		4950	10	495
DVA.5-50-45-SST-M10-55	50	45	M10	10	118		1605	11	142	410457	2510	11	223		4810	11	427
DVA.5-50-50-SST-M10-55	50	50	M10	10	123	ON REQUEST	1610	12	129	410458	2570	12	206	ON REQUEST	4860	12	389
DVA.5-60-30-SST-M10-55	60	30	M10	10	141		2800	8	373	410461	4350	8	580		7500	8	1000
DVA.5-60-40-SST-M10-55	60	40	M10	10	170		2600	10	260	410462	3540	10	354		4640	10	464
DVA.5-60-50-SST-M10-55	60	50	M10	10	205		2900	13	232	410463	4370	13	350		9500	13	760
DVA.5-70-30-SST-M10-55	70	30	M10	10	195		4930	8	657	410470	7170	8	956		13070	8	1743
DVA.5-70-40-SST-M10-55	70	40	M10	10	255		3850	10	385	410471	6280	10	628		15280	10	1528
DVA.5-70-45-SST-M10-55	70	45	M10	10	275		3700	11	329	410473	6750	11	600		8800	11	782
DVA.5-70-55-SST-M10-55	70	55	M10	10	341		3320	14	241	410475	5770	14	420		9510	14	692
DVA.5-75-25-SST-M12-55	75	25	M12	12	205		6560	5	1312	410481	9660	5	1932		20780	5	4156
DVA.5-75-30-SST-M12-55	75	30	M12	12	210		5400	8	720	410483	8700	8	1160		15400	8	2053
DVA.5-75-40-SST-M12-55	75	40	M12	12	290		5010	10	501	410485	6680	10	668		9170	10	917
DVA.5-75-50-SST-M12-55	75	50	M12	12	345		3970	13	318	410487	5570	13	446		13550	13	1084
DVA.5-75-55-SST-M12-55	75	55	M12	12	348		5050	13	367	410489	6820	13	496		10590	13	770
DVA.5-100-40-SST-M16-55	100	40	M16	16	485		9430	10	943	410491	12110	10	1211		24190	10	2419
DVA.5-100-50-SST-M16-55	100	50	M16	16	580		8320	13	666	410493	14040	13	1123		22900	13	1832
DVA.5-100-55-SST-M16-55	100	55	M16	16	583		7820	13	568	410492	12730	13	925		22800	13	1658
DVA.5-100-60-SST-M16-55	100	60	M16	16	720		7440	15	496	410495	12950	15	863		21450	15	1430
DVA.5-125-55-SST-M16-55	125	55	M16	16	1050		21217	14	1543	410496	23790	13	1809		23751	11	2102
DVA.5-125-75-SST-M16-55	125	75	M16	16	1212		18723	19	999	410497	22314	19	1190		25000	18	1420
DVA.5-150-75-SST-M20-55	150	75	M20	20	1325		18050	18	962	410494	27800	18	1482		28600	11	2600
DVA.5-200-100-SST-M20-55	200	100	M20	20	1950		9280	8	1160	410498	11540	8	1442		22770	5	4554



Vibration damping elements